

DBLING
c:\cadd\design\774645es.569
03/27/01 10:33:17 AM
STARTING DATE: 7/24/00
DATE LAST REV.:
DRAWN BY: A.W. SMITH
ENGR. CHK. BY: S. MORAN
PROJ. MGR.: J. YACOB
INITIATOR: D. LAMB
DWG. NO.: 774645es.569
PROJ. NO.: 774645

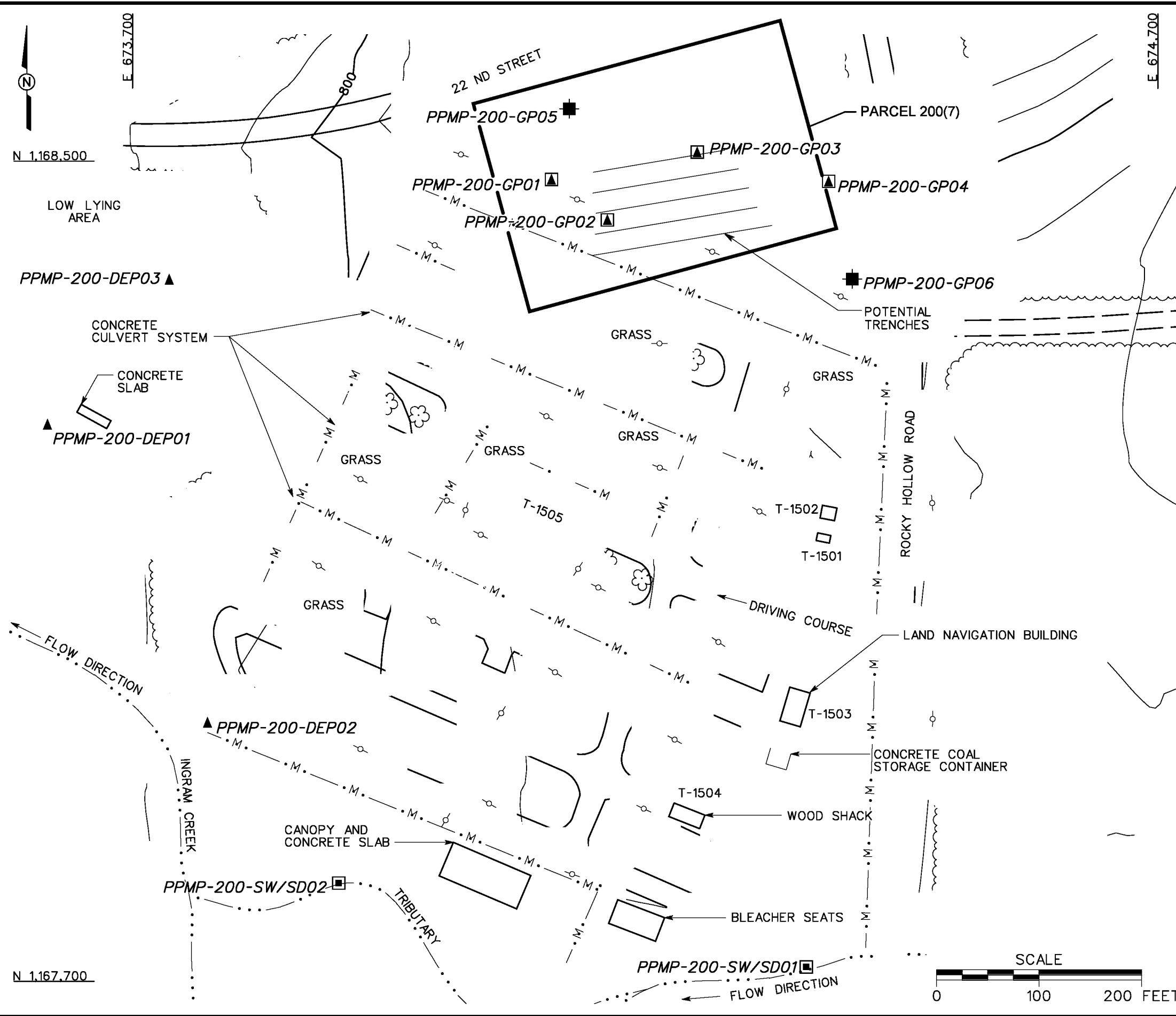

- LEGEND**
- UNIMPROVED ROADS AND PARKING
 - PAVED ROADS AND PARKING
 - BUILDING
 - TOPOGRAPHIC CONTOURS (CONTOUR INTERVAL - 5 FOOT)
 - TREES / TREELINE
 - PARCEL BOUNDARY
 - UTILITY POLE
 - BRIDGE
 - CULVERT WITH HEADWALL
 - SURFACE DRAINAGE / CREEK
 - MANMADE SURFACE DRAINAGE FEATURE
 - SURFACE WATER/SEDIMENT SAMPLE LOCATION
 - SUBSURFACE SOIL SAMPLE LOCATION
 - GROUNDWATER, SURFACE AND SUBSURFACE SOIL SAMPLE LOCATION
 - DEPOSITIONAL SOIL SAMPLE LOCATION

FIGURE 3-2
SAMPLE LOCATION MAP
GROUND SCAR WITH TRENCHES
AT DRIVING COURSE
PARCEL 200(7)